

Section VI

Hydraulic Replacement Parts - 1800 & 1901

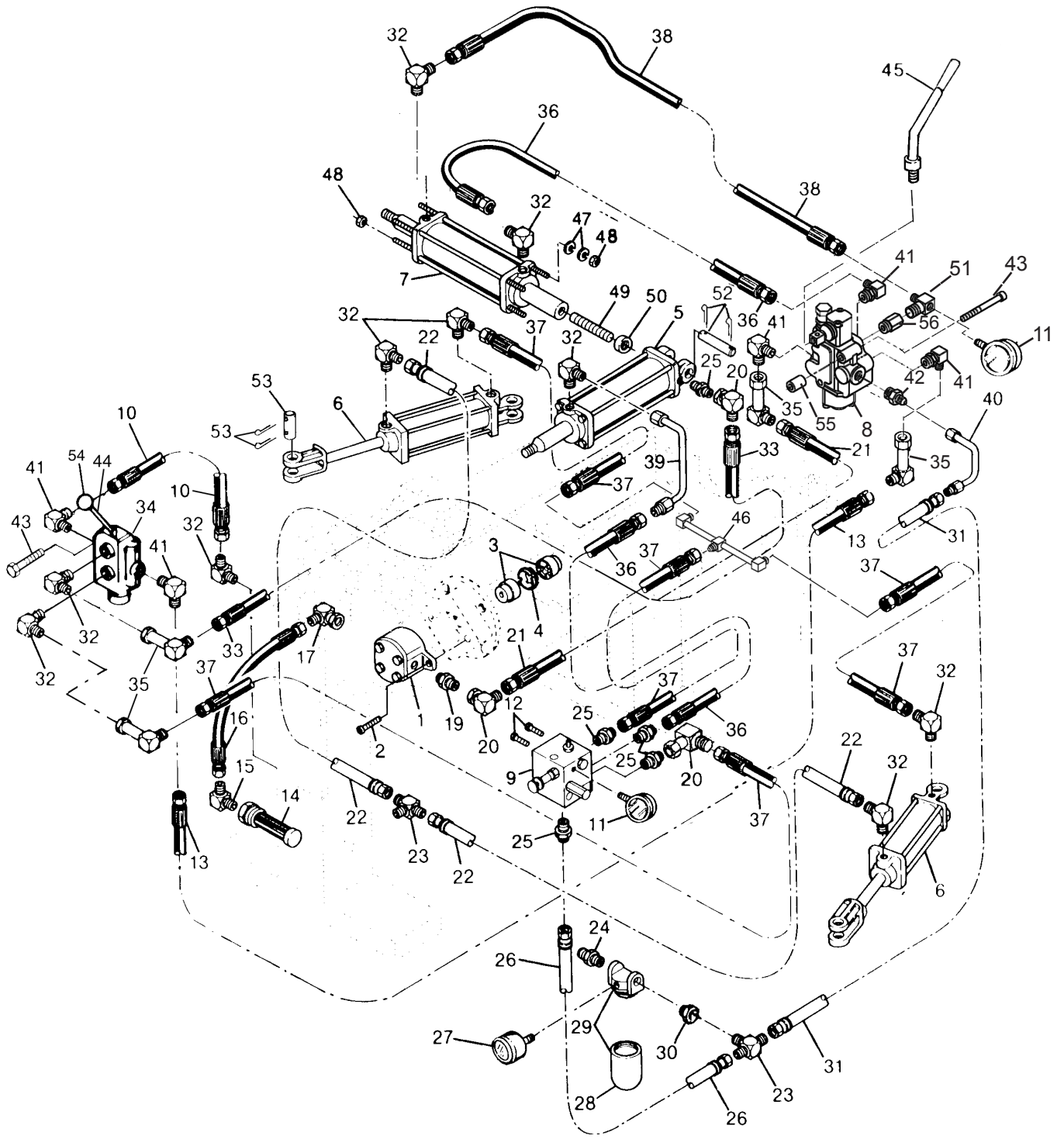

Hydraulic Replacement Parts - 1800 & 1901

| KEY | PART NO. | DESCRIPTION | QUANTITY | | REMARKS |
|-----|----------|---|----------|------|---|
| | | | 1800 | 1901 | |
| 1 | 92116 | Pump, Hydraulic | 1 | 1 | |
| | 92117 | Pump, Hydraulic (High Speed) | 1 | 1 | High Speed Option for 7½ H.P Motor |
| 2 | 97267 | Bolt, Hex Hd. 3/8"-16 x 1" | 2 | 2 | |
| 3 | 92357 | Coupler | 1 | 1 | Includes P/N 92358 Spyder |
| 4 | 92358 | Spyder, Rubber | 1 | 1 | |
| 5 | 92169 | Cylinder, Main Industrial | 1 | - | Includes Pins |
| | 92235 | Seal Kit | 1 | - | Includes All Seals For P/N 92169 |
| | 92161 | Rod, Tie | 4 | - | For P/N 92169 |
| | 92048 | Cartridge, Packing Gland | 1 | - | Sold Without Seals For P/N 92169 |
| | 92158 | Cylinder, Main Agricultural | - | 1 | Sold As Assembly Only |
| | 92208 | Seal Kit for 92158 | - | 1 | For Benders Built After 3/1/91 |
| 6 | 92150 | Cylinder, Side Industrial | 2 | - | Includes Pins |
| | 92236 | Seal Kit for 92150 | - | 1 | Includes All Seals For P/N 92150 |
| | 92159 | Cylinder, Side Agricultural | - | 2 | Sold as Assembly Only |
| | 92207 | Seal Kit for 92159 | - | 2 | |
| 7 | 92256 | Cylinder, Double End, Ag. | - | 1 | Sold as Assembly Only |
| | 92209 | Seal Kit for 92256 | 1 | 1 | For Benders Built After 3/1/91 |
| | 92355 | Cylinder, Double End, Ind. 3" | 1 | 1 | |
| | 92205 | Seal Kit for 92355 | 1 | 1 | |
| 8 | 92103 | Valve, Swager | 1 | 1 | |
| 9 | 92051 | Valve, Sequence | 1 | 1 | |
| 10 | 92278 | Hose, Return #6, 15" Lg. | 1 | 1 | |
| 11 | 92100 | Gauge, Pressure | 2 | 2 | |
| 12 | 97221 | Bolt, Hex 3/8"-16 x 1/2" | 2 | 2 | |
| 13 | 92276 | Hose, #6, 62" Lg. | 1 | 1 | |
| 14 | 92045 | Filter, Easy Flow | 1 | 1 | |
| 15 | 92010 | 90 Ftg, 1/2ML NPT x 3/8ML JIC | 1 | 1 | |
| 16 | 92272 | Hose, #8, 18" Lg. | 1 | 1 | |
| 17 | 92077 | Elbow, 90 Degrees, 8-8 | 1 | 1 | |
| 19 | 92026 | Str Ftg, 5/8 SAE O'R x 3/8ML JIC | 1 | 1 | |
| 20 | 92021 | 90 Elb, 3/8ML JIC x 3/8FM JIC SVL | 3 | 2 | For rear of Main Cyl.-Use Ref. #32 (Model 2801) |
| 21 | 92273 | Hose, #6, 41" Lg. | 1 | 1 | |
| 22 | 92277 | Hose, Return, #6, 24" Lg. | 2 | 2 | |
| 23 | 92015 | Branch, T Ftg, 3/8 x 3/8 x 1/4 | 2 | 2 | |
| 24 | 92028 | Str Ftg, 1/2ML NPT x 3/8ML NPT | 1 | 1 | |
| 25 | 92002 | Str. Ftg., 1/2" ML NPT x 3/8" ML JIC | 5 | 4 | |
| 26 | 92280 | Hose, Return, #6, 13" Lg. | 1 | 1 | |
| 27 | 92292 | Gauge, Filter | 1 | 1 | |
| 28 | 92290 | Filter | 1 | 1 | |
| 29 | 92289 | Filter Assembly | 1 | 1 | Includes Filter, Head & Gauge |
| 30 | 92027 | Str Ftg, 1/2ML NPT x 1/4FM NPT | 1 | 1 | |
| 31 | 92279 | Hose, Return, #6, 56" Lg. | 1 | 1 | |
| 32 | 92009 | 90 Ftg, 1/2ML NPT x 3/8ML JIC | 11 | 12 | |
| 33 | 92275 | Hose, #6, 58" Lg. | 1 | 1 | |
| 34 | 92101 | Valve, Bending Control | 1 | 1 | |
| 35 | 92023 | 90 Lg Elb, 3/8 ML JIC x 3/8FM JIC | 6 | 6 | |
| 36 | 92264 | Hose, #6, 23-1/2" Lg. | 2 | 2 | |
| 37 | 92261 | Hose, #6, 15-1/2" Lg. | 4 | 4 | |
| 38 | 92263 | Hose, #6, 19" Lg. | 1 | 1 | |
| 39 | 92312 | Tube, 6-6 | 1 | 1 | Cylinder |
| 40 | 92313 | Tube, 6-6 | 1 | 1 | Valve |
| 41 | 92004 | Str. Ftg., 1/2" ML NPT x 3/8" ML JIC | 3 | 3 | |
| 42 | 92006 | Str, 3/8ML JIC x 1/2ML SAE O'R | 1 | 1 | |
| 43 | 97206 | Socket Head Cap Screw, 3/8"-16 x 3-1/4" | 4 | 4 | |
| 44 | 92047 | Chain Link Kit | 1 | 1 | |
| 45 | 92109 | Handle, Swager | 1 | 1 | |
| 46 | 92314 | Fitting, 3-Way, 6-6 | 1 | 1 | |
| 47 | 97383 | Washer, Lock 1/2" | 8 | 8 | |
| 48 | 97208 | Nut, Jam 1/2"-13 | 6 | 6 | |
| 49 | 97051 | Stud, Thread 1-14 | 1 | 1 | |
| 50 | 97100 | Nut, Knurl | 1 | 1 | |
| 51 | 92009DT | 90 Ftg, 1/2ML NPT x 3/8ML JIC, DT | 1 | 1 | For Pressure Gauge |
| 52 | 92203 | Pin, Main Cylinder | 1 | 1 | Industrial & Agricultural |
| 53 | 92202 | Pin, Side Cylinder | 4 | 4 | Industrial & Agricultural |
| 54 | 92115 | Handle, Valve Control | 1 | 1 | |
| 55 | 70045 | Bushing, Steel | 2 | 2 | Industrial & Agricultural |
| 56 | 92008 | Str Ftg, 1/2ML SAE O'R x 1/2 FM NPT | 1 | 1 | Industrial & Agricultural |